



Houtdatabase.nl

Reference project: applications of timber in civil engineering, residential and commercial construction, edition October 2014

WWF building Zeist

Project:

Location Driebergseweg 10, 3708 JB Zeist, the Netherlands

Date of completion 2007

Wood species itauba

Certificate FSC

Country / Region of Origin Brazil

Application Indoor stairs

Additional information The new office building of the WWF in the Netherlands has been renovated only using FSC certified wood.

Supplier:

Company name Geveltim

Contact person

Address Acacialaan 47
2451 XX Leimuiden

Country the Netherlands

Telephone no. +31 (0)172-508804

E-mail Info@geveltim.nl

Website

Chain of Custody CU-COC-803072 certificate no.



Centrum Hout
Postbus 1380 / P.O. Box 1380
1300 BJ Almere
The Netherlands
tel.: +31(0)36 5329821
fax: +31(0)36 5329571
houtinformatie@centrum-
hout.nl
www.centrum-hout.nl



Stichting Probos
Hollandseweg 7g
Postbus 253 / P.O. Box 253
6700 AG Wageningen
The Netherlands
tel.: +31(0)317 466555
fax: +31(0)317 410247
mail@probos.nl
www.probos.nl

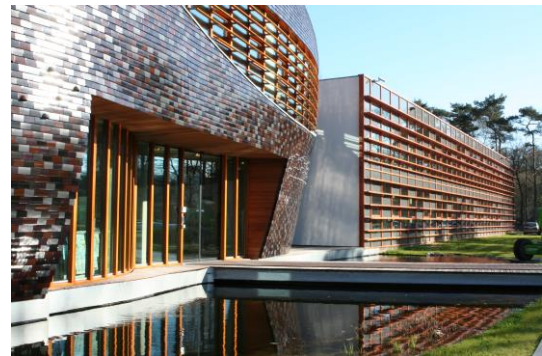

Part of the database

'Wood species for residential construction, commercial construction and civil engineering'
created by Probos en Centrum Hout